

What is Wise Move?

A swap between one under-occupying property and one overcrowded property. It can be two or more properties in one go.

A swap is often the quickest way to move home. It means you don't have to wait months, or even years, to find a suitable vacant home and is a great option for escaping the effects of the bedroom tax if you are under occupying your home.

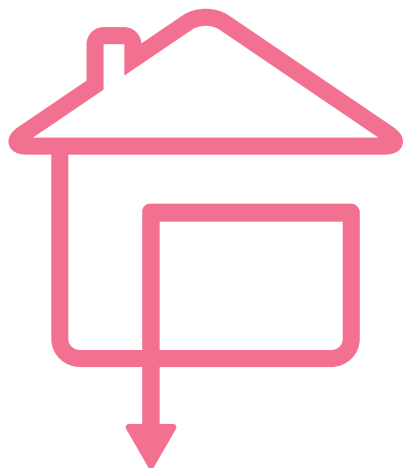

Contact the Welfare Solutions Team

When you have found a property that suits what you are looking for and what they are looking for you can contact us on the following channels:

- ☎ 020 7926 639?
- ✉ CItenquiries@lambethliving.org.uk
- 🌐 www.lambethliving.org.uk/benefit-changes

Please make sure you have the reference numbers for all relevant properties to hand.

You can also visit us in our offices at:

Second Floor – Springfield Centre
110 Union Road
SW8 2SH

Wise Move

Here to help our tenants swap homes



How to find someone to swap with?

Register for Wise Move by visiting:

<https://housingmanagement.lambeth.gov.uk/swap-shop-register>

Or calling the Wise Move team on:
020 7926 6399.

Wise Move top tips

- Check for properties on a regular basis
- Be flexible when selecting area and type of property
- Know what type of tenancy you could be taking on as there are differences between housing associations and local authority tenancies
- Try to rectify any outstanding repairs

You and your potential swapper will complete an MEX1 form to start the 42 day exchange process. We will inspect your property and reference all tenants in the exchange. If successful you will sign the new tenancy agreements and prepare to move.

What happens once I have found an exchange?

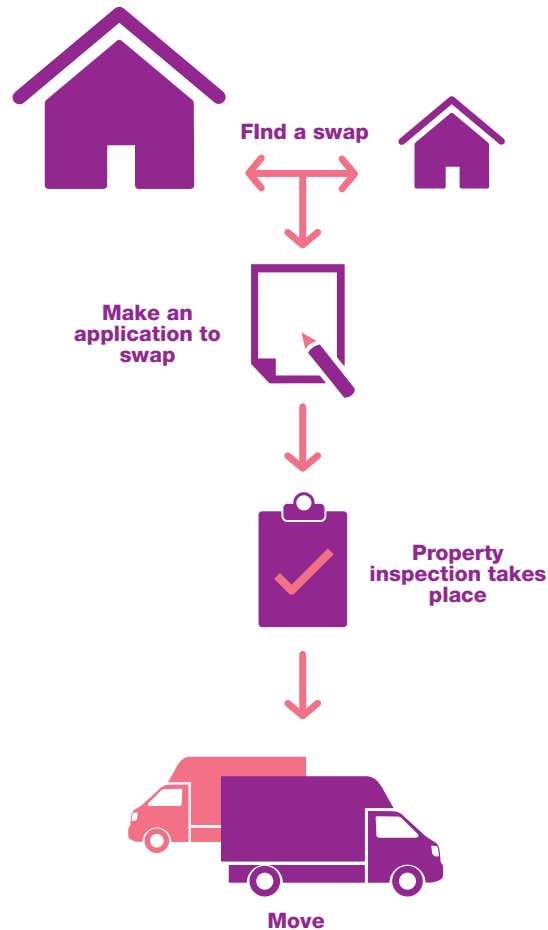

Potential pitfalls and rewards

Can an exchange be refused?

An exchange can be refused if:

- If you or the person you wish to swap with has a possession order on the properties.
- If the property to be exchanged is not suitable for you or the tenant you are swapping with.
- If you have arrears outstanding repairs issues.

Am I eligible for a transfer incentive?

- For every room that you give up you could be eligible for £500.
- Each household must be moving into their correct property size to be eligible for this payment.